

THE LOWRY

Technical Specification

The Lyric Theatre

**The Lowry
Pier 8
Salford Quays
M50 3AZ**

Get In

Under cover loading bay for three trucks maximum trailer height 4.5m (14ft 6inch)
(2 for the Lyric Theatre and 1 for The Quays Theatre)

Please confirm parking requirements prior to get-in

Bay dimensions: 10.5m (W) x 15.0m (D) x 4.5m (H)

Trucks load into scene store located to the rear of the Lyric stage.

Loading bay floor level to scene store floor level: 1.2m – Dock levellers installed.

Dimensions of dock doors: 6.3m (W) x 3.1m (H)

Scene store dimensions: 14.8m widest point (W) x 14m (D) x 10.5m (H)

Dimensions of opening from scene store to stage: 12m (W) x 9m (H)

Scene store and stage separated by a vertically moving sound / fire door.

(Cannot be open during performance)

Stage Area

Type of stage: Proscenium

Depth of stage from setting line to rear stage wall: 16.2m (Setting line to last flying bar: 14.7m)

Setting line to front of apron: 800mm

Distance from front of apron to rear of safety curtain: 1200mm

Proscenium width: 14m

Proscenium height: 11.2m

False pros variable height (5.5m to 9.5m) and variable width (8.3m to 13.8m)

Maximum width of stage: 29m to counterweight frame stage right

Clear height to grid: 23m

Clearance under lowest stage gallery: 9.5m

Stage floor flat. Hardboard on plywood sub base resting on resilient pads on battens and sleepers. Paint finish, matt black.

Stage floor loading capacity: 7.5kN/sq.m plus point loads of 10kN @ 1.5m centres over 300mm x 300mm square area. **Please check with technical department.**

Seating capacity

Stalls: 712 max (708 with house seat holds)

Circle: 358

Boxes: 48

Upper Circle Lower section: 297

Upper Circle Top section: 281

Total seated: 1,696

Standing: 41

The following must be confirmed at contract stage

Small sound position removes 11 seats

Large sound position removes 14 seats

Small pit removes 17 seats

Medium pit removes 68 seats

Large pit removes 127 seats

Auditorium treads available SL & SR - Treads removes 6 seats & can only be used with no pit

Disabled / wheel chair provision at stalls level and first tier boxes

Stage capacity

150 when in standard end on.

Orchestra Pit / lifts

Lift no. 1 17M x 2M (curved) Lowered 6 - 10 musicians (some located under stage under-hang)

Lift no. 2 17M x 2M (curved) Lowered 45 – 60 musicians (some located under stage under-hang)

Lift no. 3 17M x 2M (curved) Lowered 60 to 100 musicians (some located under stage under-hang)

Lifts 1 & 2 finished as stage floor surface. Seats removed on drivable wagon

Lift 3 finished with auditorium carpet. Seats individually removed

Pit net available for medium and large formats only

Please note that auditorium treads cannot be used with a pit format.

Backstage accommodation

Dressing rooms:
Basement:

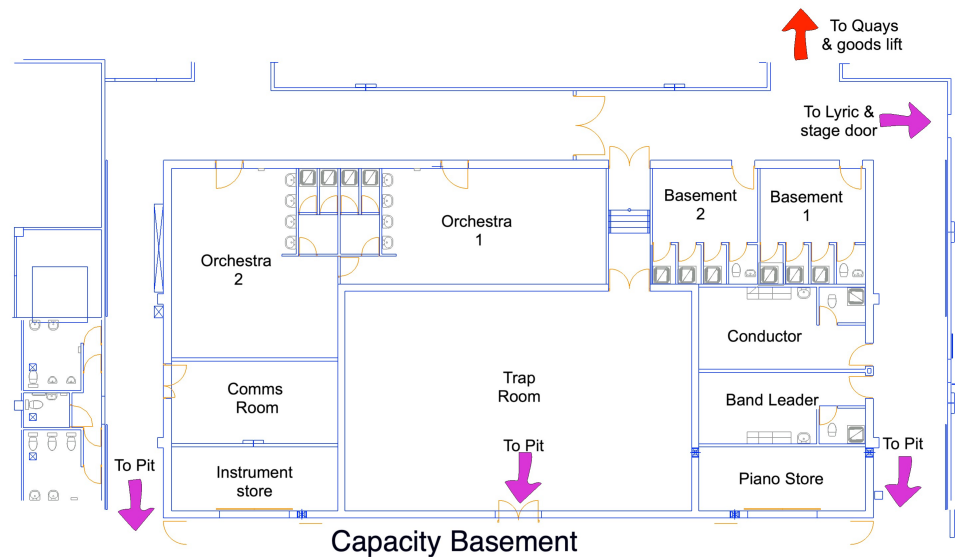

Orchestra room 1	30
Orchestra room 2	30
Conductors	5
Band Leaders	5
Basement 1	5
Basement 2	5

Stage level:

Capacity ground

- Dressing room 1
- Dressing room 2
- Dressing room 3
- Dressing room 4
- Dressing room 5
- Dressing room 6
- Dressing room 7
- Dressing room 8
- Dressing room 9
- Dressing room 10
- Dressing room 11
- Dressing room 12
- Dressing room 21

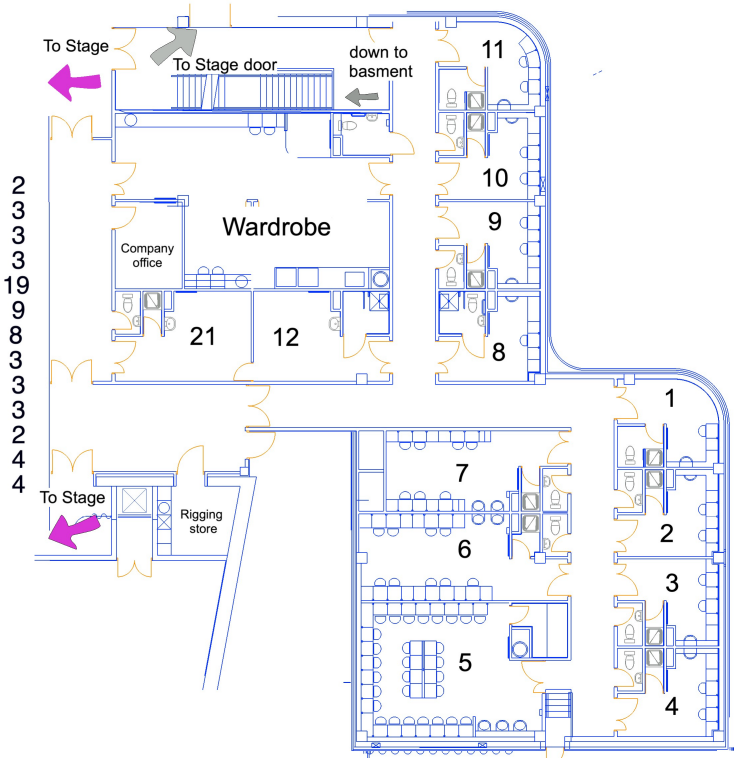

Total146

Wardrobe at ground floor/ stage level and includes 3 X industrial washing machines, 2 X industrial dryers, irons and ironing boards. (All facilities chargeable)

Visiting company office at ground floor / stage level. With 2 telephone points, desk and 13 amp power. Lockable gun cabinet. Broadband internet access is available and a charge for use applies.

Backstage cafeteria / green room at first floor level.

(Please advise of any special catering needs so arrangements can be made with our catering department)

Rigging and flying

Flying operated stage right at fly gallery level.

Automated House Tabs.

79 single purchase 500kg counterweight sets (Point load 84KG).0. Please see plan and hanging plot for available bars. (Flying plot on pages 13/14)

77 cross stage and 2 up/down stage sets.

19M ladder truss pipes at 200mm centres on 6 wires. Pipe extensions available.

Pipe travel: 1170mm above stage floor to 450mm below grid.

Counterweight sets 6, 24, 42, & 60 are **NOT** suitable for 'live' flying as they are situated behind structural RSJ's. Please contact the Technical Office for more information.

14M of Milos QTP truss per side stage each hung on 3 x 1000kg chain motors up/down

11M of Milos QTP truss hung on 4 x 1000kg chain motors of FOH

2 x FOH 2000kg chain motors hung on roller beams for PA hangs

(An NRC House Familiar Rigger is required for use of these for PA hangs; cost of which is rechargeable)

8 x Grid frames points & a selection of beam spreaders are available please ask for details

8 x wall anchor points are located on the stage left wall & anchors from the counter weight frame on stage right are available

Loose Truss and Motors (shared between venues)

2 x 2.5M Litec QX30SA truss

5 x 1M Litec QX30SA truss

11 x 2M Litec QX30SA truss

4 x 90° Litec QX30SA corner pieces

14 x 1T loadstar motors

2 x 500KG loadstar motors

2 x 4 way motor controllers

(An NRC House Familiar Rigger is required for use of these; cost of which is rechargeable)

Staging and rostra shared between venues POA

25	8'x4'
8	4'x4'
4	4' triangles
4	4' Quadrant
2	Treads
13	8' handrails
8	4' handrails

A selection of pre-cut legs are available, please contact for more details, Requests for specific sizes can be taken but charges will be applicable. As we have many different leg sizes, we do not supply skirts for the decking.

Masking

Adjustable proscenium flown on two sets.

Header on CW3 track with hard legs on CW4 - These are fixed.

A full stock of black serge masking.

Leg	5 sets	12M	5M
Full blacks	2 sets	12M	2X 10M
Full blacks	1 (shared between venues)	9M	9.9M
Borders	5	6M	19M
Border	1	3M	19M
Cyc	1	12M	19M
Black gauze	1	12M	19M
White gauze	1	12M	19M

Licensing Requirement

All scenic elements should be made up from non-combustible material and/or inherently flame retardant fabrics. Timber scenery should meet Class 1 when tested in accordance with BS 476 Pt 7. The scenery should be visibly stamped to this effect or its standard should be supported by suitable certification.

Access equipment (shared between venues and subject to availability)

2 Genie GR-20, platform height 6M, **IPAF (3a) or equivalent required.**

1 Genie AWP-36S push around, platform height 11.1M **IPAF (1a) or equivalent required**

1 Large Tallescope platform height 7.5m

1 Medium Tallescope platform height 5.9M

Stepladders, hand trucks etc. Please call the technical dept. for full details.

Temporary electrical supplies

Scene store	1x	125A	SPN	BS 4343 socket
	2x	125A	TPN	BS 4343 socket
	1x	63A	TPN	BS 4343 socket
	3x	63A	SPN	BS 4343 socket (1 diverted to truck bay)
	1x	32A	TPN	BS 4343 socket
Down stage left		400A	TPN	Power Lock (Veam Connectors ONLY)
	2x	125A	TPN	BS 4343 socket
	2x	63A	TPN	BS 4343 socket
	1x	32A	TPN	BS 4343 socket
Up stage right	1x	125A	TPN	BS 4343 socket
	3x	63A	TPN	BS 4343 socket
	1x	32A	TPN	BS 4343 socket
Grid level stage left	1x	125A	TPN	BS 4343 socket
	2x	63A	TPN	BS 4343 socket
	1x	32A	TPN	BS 4343 socket
Downstage right		200A	TPN	Power Lock (Veam Connectors ONLY)
Fly floor stage right	1x	63A	TPN	BS 4343 socket
	1x	32A	TPN	BS 4343 socket

Clean earth supplies:

Scene store	125A	SPN	BS 4343 socket
Stage left and stage right	125A	SPN	BS 4343 socket
Adjacent to all sound boxes	13A	SPN	BS 4343 twin sockets

Stage lighting

Control

Lighting control room is situated to the rear of the stalls level with access to the stalls and foyer. Space available for touring console.

Control suite consists of three rooms with interlocking doors, suitable for wheel chair access.

Lighting control – house right – with opening window

Sound control - house centre – with no window

Broadcast / translation room – house left – fixed window

Console:

ETC Gio 4k With 2 x 20 fader wing & 2 x 23inch touch screen

ETC Ion with 2 x 20 fader wing and 2 x 23 inch display (back up / plotting)

1 X rack mounted 4 port NET3 ACN gateway (universe 1,2,3,4)

House lights and working lights are controllable via ETC Paradigm as DMX channels from the lighting desk on a HTP precedent.

Dimmers

7 X 96-way ETC sensor 3 dimmers containing. 504 x 3KW and 30 x 5KW with 60 fixed 3KW Non dims and 8 5KW non dims, Please enquire re distribution.

These are controlled via sACN on our ETC network with a DMX input either DSL or in the control room. PLEASE DO NOT PLUG INTO OUR NETWORK.

Building wide Howard Eton DMX and Ethernet System and Patch which crosses over into the ETC network in the dimmer room.

All overhead dimmer outlets are via SOCAPEX connection. All on stage are 15A outlets

Lighting Positions

Front slots left and right (Pros boom position)

Rear slots left and right (In line with the dress circle ends)

First tier front and sides (Dress circle front)

Second tier front and sides (Upper circle front)

Bridge 1 (12m above stage level 3.3m from the iron line) not suitable for performance

Bridge 2 (16m above stage level 11.3m from the iron line)

Bridge 3 (16.5m above stage level 16m from the iron line)

Followspot room (16.5m above stage level 19m from the iron line)

Promenade left and right (At the side of the 2nd level of the upper circle)

Lantern Stock

N.B. Lighting equipment must be rigged & de-rigged for each visiting company.
The only fixed element of the lighting system is the standard FOH rig & followspots.
Any items moved must be re-rigged as part of the get-out

Bridge 2 (FOH 1)

18	14° ETC Source 4	750W
----	------------------	------

Bridge 3 (FOH 2)

12	14° ETC Source 4	750W
6	14° ETC Source 4 HD Tungsten	208W

Slot 1 (Pros boom)

No fixed units

Slot 2

12	19° ETC Source 4 <small>6 per side</small>	750W
2	Strand Cantata 11/26 <small>Logo gobo</small>	1.2KW

Promenade

8	14° ETC Source 4 <small>6 per side</small>	750W
2	Strand Cantata 11/26 <small>Logo gobo</small>	1.2KW

Upper circle

8	19° ETC Source 4	750W
2	Freedom Fresnels	600W

Dress circle

2	Freedom Fresnels	600W
---	------------------	------

Followspots

2	Robert Juliat Arthur	800W LED
---	----------------------	----------

Loose Equipment

Lanterns are shared between the 3 theatres & must be booked in advance. The Quays Theatre comes with the standard FOH rig as default, and follow spot. Charges apply to some items, which are marked POA.

Other items listed require advance booking notice of at least 4 weeks, as they will need servicing before use & this will also carry an extra charge.

Profiles

27	Strand SL 15/32	600W
20	Strand SL 23/50	600W
8	ETC S4 19°	750W
16	ETC S4 26°	750W
16	ETC S4 36°	750W
12	Selecon SPX 15/35	800W
12	Selecon SPX 25/50	800W

Fresnels / PC's

18	Alto Fresnel	2.5KW
65	Cantata Fresnel	1.2KW
16	Cantata PC	1.2KW

Par Cans

92	Par 64 (50 xCP62: 24xCP61: 6xCP60; 12 x CP62 scroller cans)	1KW
24	Par 64 CP62 (mounted on 2x 6way bars)	1KW
12	Par 64 CP61 (mounted on 2x 6way bars)	1KW
6	Par 64 CP60 (mounted on 1x 6way bar)	1KW
12	Barn doors	
16	ETC source 4 Pars	575W
12	ETC ColorSource Deep Blue LED Par with MFL filter	89W

Floods

7	ETC ColorSource Cyc flood LED (POA)	116W
---	-------------------------------------	------

Moving Lights POA

6	Martin MAC 700 profile	700W
22	Chauvet Rogue R2 LED wash	324W
16	Martin TW1 80v	1.2KW

Require maintenance on request

4	Toccata 10/26 profile	2.5KW
4	Toccata 15/28 profile	2.5KW
16	Alto PC	1.2KW
24	Par 64 floor cans (10xCP62: 10xCP61: 4xCP60)	1KW
6	ETC source 4 Pars	575W

Miscellaneous items POA

3 x ETC 2 port, portable NET3 ACN gateway (can be input or output)
1 x ETC 1 port, portable NET3 ACN gateway (can be input or output)
1 x MDG Atmosphere hazer
1 x MDG ATme hazer
3 x Look Solution Unique 2 hazers
2 x Look Solution Viper NT fog generators
1 x Look Solution Tiny C07 small battery-driven fog generator
2 x 16inch mirror balls
1 x Anytronics DMX strobe
2 x Thunderdroom 3000 DMX strobe
1 x 6 way Le-Maitre Pyro firing unit
1 x Bomb tank
10 x Le-Maitre pyro firing pods – 2 x angled pods
Various birdies, various stands/cables/multicores etc.
60 x RAT music stands shared between venues

Visiting companies must supply their own gel though a small stock of Pre-cut colour is available F.O.C.

Use of Pyrotechnics, smoke, vapour, laser & other special effects.

The Lowry MUST be informed prior to the production arriving at the venue that a company intends to use special effects. The full details along with risk assessments must be supplied and in some cases these need to be passed to the licensing authorities before authorisation to use them is granted.

Updated 08/06/2022

Audio tie line infrastructure

48 way starquad audio tie line loop for microphone circuits, terminating on 3 x 16 way multipin sockets at each stage corner, orchestra pit, sound control room and mixing location centre stalls.

32 way starquad audio tie line loop for output/return circuits, terminating on 2 x 16 way multipin sockets at the sound control room, mixing location centre stalls, audio rack room, communications rack room, stage left and right touring sound location.

Loudspeaker line infrastructure

Bi-amped loudspeaker lines on NL4 sockets to stage, sub-stage, pit, fly galleries, proscenium slots. Non bi-amped loudspeaker lines to side and rear auditorium at all levels and to under balcony delay locations. Loudspeaker lines terminate on loudspeaker patch in coms rack room, with bi-amped lines to off stage left and right touring sound locations.

Sound mixing console

Soundcraft Vi1000 Digital Console with digital stage box

Subject to availability alternative house consoles are:

Soundcraft Vi3000 Digital Console with digital stage box

Yamaha LS9-16 Digital Console

Allen & Heath Mix Wizard 14:4:2 10 mic channels/2 Stereo Channels

The console is normally located in the sound control room to the rear of the stalls level. The room is open to the auditorium with no window. A position is available immediately in front of the control room on request, dimensions for this auditorium positions are 3.6M X 1.75M (large), 2.3M x1.75M (small) this does result in a loss of seating capacity.

This position is subject to management agreement & must be agreed at contract as seats need to be removed from sale.

Installed loudspeaker system

(Suitable for spoken word, theatre playback, comedy, jazz & folk music; for music gigs we would recommend the hire or supply of additional Left/Right or flown PA; these costs are re-chargeable)

Loudspeakers installed

Loudspeaker system processing: A&H iDR8/16

Proscenium:	6 x Meyer MSL2-1C	4 inputs Stalls L/R, Circle & Tier L/R
Side fill:	2 x Meyer UPA-1C	2 input L&R
Stalls Sub bass:	2 x D&B B22	1 input
Upper Circle Sub bass:	2 x Meyer USW-1	1 input
Front fill:	6 x D&B E6	2 inputs Inners & outers
Stalls Delays:	8 x D&B E6	2 inputs Inners & outers
Circle Delays:	8 x D&B E6	2 inputs Inners & outers
3 rd Tier Delay:	7 x Meyer UPM-1	1 input
Central cluster:	4 x Meyer UPA-1A	2 inputs upper & lower

(2 additional MSL2's can be added to the stalls for additional level & coverage)

Loudspeakers non-installed (Subject to availability & a hire cost; up to 4 wedges are included per venue)

Foldback / effects:	6 x APG DX12 (can run as 6 mixes, 6 flying Frames available)	
	8 x APG DX15 (can run as 8 mixes)	
	8 x Nexo PS-15 (Can run as 6 mixes; 6 flying frames available)	
	2 x Meyer UPA 1P (Self Powered; No flying frames)	
	4 x Meyer UPA 1C (4 channels of amps; 4 flying frames available)	
Extra Sub bass	2x Nexo LS-1200 (Can run with PS15 as Drum fill or extra FoH)	
Power amplifiers:	APG	SA 30:2
	Lab Gruppen	1300C

Outboard equipment

- 1 x PC with control of iDR8 processor & EQ for FOH system
- 1 X Mac Mini with Q-Lab 3 and Q-lab 4 & Saffire PRO 40 Focusrite sound card
- 1 x MacBook pro with Q-lab 3 and Q-lab 4 (poa)
- 1 x Neumark twin Compact disc –player

Extra outboard equipment available

(This equipment is shared between 3 theatre spaces corporate facilities & must be booked in advance)

- 3 x XTA GQ600 Two channel 1/3 equaliser
- 1 x BSS DPR504 Four channel noise gate
- 1 x TC electronic D-Two Delay
- 1 x Yamaha SPX2000 Digital effects (in with Vi 3000)
- 1 x Roland RD-700 Electric piano

Microphones

(This equipment is shared between 3 theatre spaces corporate facilities & must be booked in advance)

- | | |
|-----------------------------------|--------------------------------|
| 8 x Shure Beta 58 | 1 x AKG 414B-ULS |
| 8 x Shure 58 | 2 x AKG 414B-XLS |
| 4 x Shure Beta 57 | 8 x AKG CK91 |
| 4 x Shure 57 | 2 x Beyer 201 |
| 2 x Shure Beta 87 | 2 x Beyer M88 |
| 5 x Sennheiser MKH40 | 1 x Beta Shure 52 |
| 2 x Sennheiser MKH60 | 4 x DPA 4099 (Classical kit) |
| 4 x Sennheiser E604 Evo drum mics | 2 x Budget switched vocal mics |
| 8 x Crown PCC160 | 10 x BSS Active D |

Radio microphones (Subject to availability and a hire cost)

- 1 x Shure ULX-D 2 way receiver racks
- 2 x Shure ULX-D 4 way receiver racks
- 4 x Shure ULX-D Handheld radio mics with SM58 or SM58 Beta
- 2 x Shure ULX-D Handheld radio mics with SM58
- 6 x Shure ULX-D body pack
- 6 x Shure MX 185 clip mic heads
- 6 x DPA 4061 clip mic heads
- 6 x DPA 4066 head mics
- 2 x Shure GLX-D 2.4Ghz SM58 systems (Suitable for Q&A; God Mic use etc)

Selection of stands, cables, connectors are available.

Please check with the technical department for frequencies available for toured equipment. Please note we hold a venue licence for shared channel 38 but this may be allocated to another production. Please be advised that Media City is

located next to our venue and uses some Channel 38 radio mics, we would always recommend using site specific licenced channels where possible. We hold 23 spot frequencies on channel 40-45 which are allocated to our own theatre radio mics & corporate AV department radio mics. By request 5 of these frequencies are available for tour use. On occasion we are able to release spot frequencies held for house equipment to allow tours to book whole blocks of channels. This must be agreed in advance and requires us as the venue to authorise their release to OFCOM :

626.000(40); 626.600(40); 630.850(41); 636.600(41); 638.200(42)

Specific frequency allocations MUST be approved in advance of arrival to avoid issue with other productions & events taking place at the same time. The Lowry will not permit the use of radio equipment without this advanced detailed notice.

Loudspeaker & Floor Mounted Equipment.

The visiting producer shall ensure that the location of speaker stacks where possible are located upstage of the fire safety curtain, and that if speakers must be located beyond this point that they are securely fixed, do not obstruct sightlines and provide a minimum of 3m separation to the nearest seat which will require the removal of seats from sale prior to the engagement.

In all circumstances no equipment shall obstruct the fire safety curtain.

Stage managers desk; Ring intercom & Video System

A mobile GDS SM desk connects either stage left or stage right, paging control and four-channel Clearcom Helixnet intercom master station & cue light control, patchable system with

boxes normally located at LX control, sound control & fly floor please check for availability of Q-lights boxes. The desk is equipped with 3 colour video monitors. A BNC 75ohm patching system with distribution is available. 2 video cameras: 1 x colour, 1 x IR Camera Show relay and call system to backstage areas are installed.

Clear-com digital Helixnet party line coms system & 4 way 2 channel RTS radio coms system is installed. Helixnet twin channel belt packs and headsets are located at LX control, sound control, fly floor, follow-spots & Stage Mangers desk. Please check for availability of additional sets.

Assisted listening system

Two channel Sennheiser infrared listening system suitable for use by hearing impaired persons & audio description.

A Sennheiser Mobile Connect system is installed for customers to access show relay and audio description, when available, via compatible mobile devices.

AV Equipment

Subject to availability and a hire cost:

1 x Panasonic PT-DZ770EJK (7,000 Lumen single chip DLP projector).

1 x Panasonic RZ970 (10,000 Lumen, laser light source)

Each projector has a flying frame supplied with a lens which we have the options of a Standard lens (1.7 – 2.3) or Short throw lens (0.8 –1).

1 x 4.2m x 3.6m screen with front and rear surface options is available (This gives a 16x9 ratio screen size)

A MacBook Pro can be supplied for PowerPoint; Keynote or QLab3 and Q-lab 4 (Stereo Audio only from the on-board sound card)

Other projector options are hired in from a local AV firm whom we are able to obtain competitive rates from. Please enquire if you have a specific AV set-up you require.

500KG UDL 85kg point load

Bar No.	From edge of stage	From CW 2 (setting line)	From CW 6	Notes
1	1.3	-0.2	-1	Surtitles only

2	1.5	0	-0.8	House Tabs
3	1.7	0.2	-0.6	Hard Header
4	1.9	0.4	-0.4	Adjustable Pros Panels
5	2.1	0.6	-0.2	Show Cloth Only
6	2.3	0.8	0	Not Suitable For Live Flying
7	2.5	1	0.2	
8	2.7	1.2	0.4	
9	2.9	1.4	0.6	
10	3.1	1.6	0.8	
11	3.3	1.8	1	
12	3.5	2	1.2	
13	3.7	2.2	1.4	
14	3.9	2.4	1.6	
15	4.1	2.6	1.8	
16	4.3	2.8	2	
17	4.5	3	2.2	
18	4.7	3.2	2.4	
19	4.9	3.4	2.6	
20	5.1	3.6	2.8	
21	5.3	3.8	3	
22	5.5	4	3.2	
23	5.7	4.2	3.4	
24	5.9	4.4	3.6	Not Suitable For Live Flying
25	6.1	4.6	3.8	
26	6.3	4.8	4	
27	6.5	5	4.2	
28	6.7	5.2	4.4	
29	6.9	5.4	4.6	
30	7.1	5.6	4.8	
31	7.3	5.8	5	
32	7.5	6	5.2	
33	7.7	6.2	5.4	
34	7.9	6.4	5.6	
35	8.1	6.6	5.8	
36	8.3	6.8	6	
37	8.5	7	6.2	
38	8.7	7.2	6.4	
39	8.9	7.4	6.6	
40	9.1	7.6	6.8	
41	9.3	7.8	7	
42	9.5	8	7.2	Not Suitable For Live Flying
43	9.7	8.2	7.4	
44	9.9	8.4	7.6	
45	10.1	8.6	7.8	
46	10.3	8.8	8	
47	10.5	9	8.2	
48	10.7	9.2	8.4	
49	10.9	9.4	8.6	
50	11.1	9.6	8.8	
51	11.3	9.8	9	
52	11.5	10	9.2	
53	11.7	10.2	9.4	

54	11.9	10.4	9.6	
55	12.1	10.6	9.8	
56	12.3	10.8	10	
57	12.5	11	10.2	
58	12.7	11.2	10.4	
59	12.9	11.4	10.6	
60	13.1	11.6	10.8	Not Suitable For Live Flying
61	13.3	11.8	11	
62	13.5	12	11.2	
63	13.8	12.3	11.5	
64	13.9	12.4	11.6	
65	14.1	12.6	11.8	
66	14.3	12.8	12	
67	14.5	13	12.2	
68	14.7	13.2	12.4	
69	14.9	13.4	12.6	
70	15.1	13.6	12.8	
71	15.3	13.8	13	
72	15.5	14	13.2	
73	15.7	14.2	13.4	
74	15.9	14.4	13.6	
75	16.1	14.6	13.8	
76	16.3	14.8	14	
77	16.5	15	14.2	
78	Stage Right	0	0	
79	Stage Left	0	0	

The Lowry Theatre
Pier 8
Salford Quays
M50 3AZ

Administration 0161 876 2020
Stage Door 0161 876 2107
Box Office 0161 876 2000
Security (24hrs) 0161 876 2111

Please can all advance show information be sent to Phil Maxim.

Head of Technical Theatre

Phil Maxim

Direct Line

0161 876 2073

Email

phil.maxim@thelowry.com

Technical Manager

David Clare

Direct Line

0161 876 2047

Email

david.clare@thelowry.com

Technical Manager

Adam Fuller

Direct Line

0161 876 2053

Email

adam.fuller@thelowry.com

Technical Manager

Andy Meyers

Direct Line

0161 876 2108

Email

andrew.meyers@thelowry.com

Technical Manager

David Wimpenny

Direct Line

0161 876 2170

Email

david.wimpenny@thelowry.com
