

# THE LOWRY

---

## Technical Specification

**The Quays Theatre**

---

**The Lowry  
Pier 8  
Salford Quays  
Manchester  
M50 3AZ**

---

## Get In

---

Under cover loading bay for three trucks maximum trailer height 4.5m (14ft 6inch)  
(2 for the Lyric Theatre and 1 for The Quays Theatre)

Bay dimensions: 10.5m (W) x 15.0m (D) x 4.5m (H)

Trucks load through the goods lift or into scene dock located to the rear of the Lyric stage, then through Quays scene dock to Quays stage. (Access via The Lyric is dependant on the shows in that spaces allowing access)

Loading bay floor level to scene store floor level: 1.2m – Dock levellers installed.

Dimensions of dock doors: 6.3m (W) x 3.1m (H)

Lyric scene store dimensions: 20m (W) x 15m (D) x 10.5m (H)

Dimensions of opening from Lyric scene store to Quays scene store: 2m (W) x 3m (H)

Quays scene store and stage separated by a pair of hinged doors, 4.1m (W) x 5.2m (H) located centrally at the rear of the stage.

Goods lift, dimensions 2.5m (W) x 4.0m (L) x 3.0m (H) the exit door on the Quays dock side is 2.4m x 2.4m

## Stage Area

---

Type of stage: End, Thrust, Promenade flat floor and in the round. No fixed proscenium.

Depth of stage from stage edge to rear stage wall: 10.2m

Adjustable proscenium formed from sliding side panels and a flown header.

Maximum width of stage: 20m (wall to wall)

*(Normal "end on" playing area is 8m deep x 10m wide. Pros opening can be set between 9m – 11m, max height of pros – 7.5m)*

Clear height to under grid: 9.80m

Flying height of bars 9.38m

Clearance under fly floors: 7.5m

Stage floor flat. English oak T&G painted with vinyl silk black paint. **Fixings into the floor are to be kept to a minimum & are at the technical departments discretion – max size of fixing is a No 8/4.5mm Screw**

## Seating capacity

---

473 End stage (with no extension & Rows A & B)

441 End stage (with extension)

400 Thrust stage

280 Flat Floor (Promenade)

*Restricted view seats vary with format*

364 Long traverse

437 Short traverse

441 In the round

A series of four lifts and seven seating wagons reconfigure the theatre for the various seating formats. Lifts finished as stage floor surface. With lift no.1 lowered, 10 – 20 musicians can be accommodated in the pit. Please note musicians only available in 'End Stage' configuration. Staging formats other than End Stage are subject to staffing costs to reconfigure the space.

## Stage capacity

---

50 when in standard end on.

80 when rows A and B are removed and treads are in place

## Backstage accommodation

### Dressing rooms

*Dressing room 14 normally used as a visiting company office and has a telephone point.*

*Telephone number - 0161 876 2118.*

*Internet access is available. Please contact for current charges.*

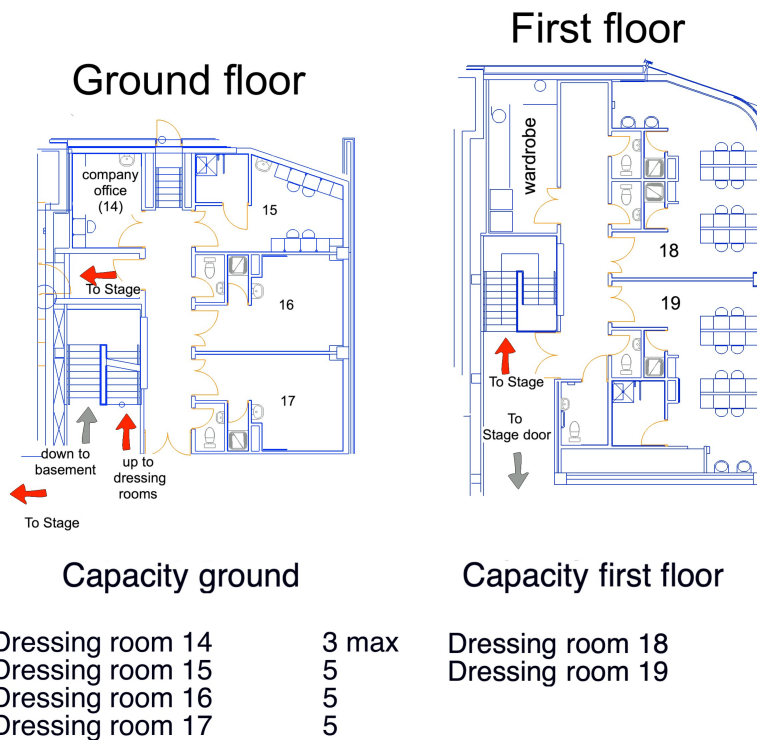

## Total 32

**Wardrobe** at first floor level access via goods lift. Lift dimensions 2.5m (W) x 4.0m (L) x 3.0m (H) and includes 2 X industrial washing machines, 2 X dryers, iron and ironing board. (All facilities chargeable)

**Visiting company office** at ground floor level. With 1 telephone point, desk and 13 amp power. Broadband internet access is available and a charge for use applies.

**Control suite** Located at the third floor tier level with access to lighting bridges, dimmer room and audio rack room. Lighting control, and followspots are also located here.

Main sound position is rear auditorium. Audio ties available in control room for small desk.

**Backstage cafeteria / green room** at first floor level.  
(Please advise of any special catering needs so arrangements can be made with our catering department)

## Rigging and flying

---

Flying system: Stage left. Suspension grid **(No full flying height please see above dimensions)**

39 single purchase counterweight sets (Flying plot on page 11)

13.5m bars at 200mm centres on five lines

34 cross stage rated at 350kg UDL, 2 up-down stage (CW's 36 & 37) rated at 300kg UDL, and CW's 38 & 39 are sets diverted to pick up over auditorium area rated at 300kg UDL

3 x 500kg electric hoists with truss for use in the FoH Grid or over stage as required

Grid surface extends over auditorium. Grid structural loading capacity: 2.5 kN/sq.m

4 x Grid frames and a selection of load spreaders are available please ask for details

8 x ground anchor points are located on the perimeter of the stage floor

4 x beam clamp anchor points are available for use in the auditorium from stock

2 x 500kg loadstar motors on grid stands for set builds

(if required to move an NRC House Familiar Rigger is required.)

**Note First useable LX bar is CW2 . The last proper flying bar is CW34, please refer to flying plot (pg 11)**

## Loose Truss and Motors (shared between venues)

2 x 2.5M Litec QX30SA truss

5 x 1M Litec QX30SA truss

11 x 2M Litec QX30SA truss

4 x 90° Litec QX30SA corner pieces

14 x 1T loadstar motors

2 x 500KG loadstar motors

2 x 4 way motor controllers

(An NRC House Familiar Rigger is required for use of these; cost of which is rechargeable)

## Staging and rostra shared between venues POA

---

25	8'x4'
8	4'x4'
4	4' triangles
4	4' Quadrant
2	Treads
13	8' handrails
8	4' handrails

A selection of pre-cut legs are available, please contact for more details, Requests for specific sizes can be taken but charges will be applicable. As we have many different leg sizes, we do not supply skirts for the decking.

## Masking

---

An adequate stock of black serge masking is available:

Leg	4 sets	8.5M	2M
Full blacks	2 sets	8.5M	2X 8M
Full blacks	1 (shared between venues)	9M	9.9M
Borders	3	3M	13.5M
Borders	4	2M	13.5M
Border	1 (permanently on bar 1)	1.5M	13M
Cyc	1	9M	13M
Black gauze	1	9M	13M
White gauze	1	9M	13M

Full tracked serge blacks on wings & US of CW 34 to form black box

## Licensing Requirements

All scenic elements should be made up from non-combustible material and/or inherently flame-retardant fabrics. Timber scenery should meet Class 1 when tested in accordance with BS 476 Pt 7. The scenery should be visibly stamped to this effect or it's standard should be supported by suitable certification.

## Access equipment (shared between venues and subject to availability)

2 Genie GR-20, platform height 6M, **IPAF (3a) or equivalent required.**  
1 Genie AWP-36S push around, platform height 11.1M **IPAF (1a) or equivalent required**  
1 Large Tallescope platform height 7.5m  
1 Medium Tallescope platform height 5.9M  
Stepladders, hand trucks etc. Please call the technical dept. for full details.

## Temporary electrical supplies

---

Gallery stage right	1 x 32ATPN	BS 4343 socket
Gallery stage right	2 x 63ATPN	BS 4343 socket
Dimmer Room FOH	(Supply shared with main dimmers) 2 x 125ATPN	BS 4343 socket

### Clean earth supplies:

Down stage right	63A	SPN	BS 4343 socket
Adjacent to all sound boxes	13A	SPN	BS 4343 twin sockets

## Stage lighting

---

### Control

Lighting control room is located on level 3 of the theatre, there is space available for a touring console in this room. An auditorium position next to the sound desk is possible but requires 6 seats to be held off prior to the show going on general sale.

ETC Gio 4k With 2 x 20 fader wing & 2 x 23inch touch screen  
ETC Ion with 2 x 20 fader wing and 2 x 23 inch display (back up / plotting)  
1 X rack mounted 4 port NET3 ACN gateway (universe 1,2,3,4)

House lights and working lights are controllable via ETC Paradigm as DMX channels from the lighting desk on a HTP precedent.

### Dimmers

LD90. 246 x 2.5kw, 14 x 5.0kw of which 114 are exclusively over the stage area  
DMX distribution system and patch  
Building wide Howard Eton DMX and Ethernet System  
All overhead dimmer outlets are via SOCAPEX connection. All on stage are 15A outlets

## Lantern Stock

---

N.B. Lighting equipment must be rigged & de-rigged for each visiting company.  
The only fixed element of the lighting system is the standard FOH rig & followspot. Iris' are available

**Any items moved must be re-rigged as part of the get-out**

### Bridge 1

3	26° ETC Source 4	750W
6	36° ETC Source 4	750W
3	36° ETC Source 4 Lustr 2	167W

### Bridge 1 side

10	ETC Source 4 par 5 per side	575W
4	26° ETC Source 4 2 per side	750W

### Bridge 2

3	19° ETC Source 4	750W
6	26° ETC Source 4	750W
3	26° ETC Source 4 Lustr 2	167W

### Bridge 2 side

4	26° ETC Source 4 2 per side	750W
---	-----------------------------	------

### Under control room

8	19° ETC Source 4	750W
---	------------------	------

### Followspots

1	Selecon Performer 1200 MSR	1.2KW
---	----------------------------	-------

## Loose Equipment

Lanterns are shared between the 3 theatres & must be booked in advance. The Quays Theatre comes with the standard FOH rig as default, and follow spot. Charges apply to some items, which are marked POA.

Other items listed require advance booking notice of at least 4 weeks, as they will need servicing before use & this will also carry an extra charge.

### Profiles

27	Strand SL 15/32	600W
20	Strand SL 23/50	600W
8	ETC S4 19°	750W
16	ETC S4 26°	750W
16	ETC S4 36°	750W
12	Selecon SPX 15/35	800W
12	Selecon SPX 25/50	800W

### Fresnels / PC's

18	Alto Fresnel	2.5KW
65	Cantata Fresnel	1.2KW
16	Cantata PC	1.2KW

### Par Cans

92	Par 64 (50 xCP62; 24xCP61; 6xCP60; 12 x CP62 scroller cans)	1KW
24	Par 64 CP62 (mounted on 2x 6way bars)	1KW
12	Par 64 CP61 (mounted on 2x 6way bars)	1KW
6	Par 64 CP60 (mounted on 1x 6way bar)	1KW
12	Barn doors	
16	ETC source 4 Pars	575W
12	ETC ColorSource Deep Blue LED with MFL filter (POA)	89W

### Floods

7	ETC ColorSource Cyc flood LED (POA)	116W
---	-------------------------------------	------

### Moving Lights POA

6	Martin MAC 700 profile	700W
22	Chauvet Rogue R2 LED wash	324W
16	Martin TW1 80v	1.2KW

### Require maintenance on request

4	Toccata 10/26 profile	2.5KW
4	Toccata 15/28 profile	2.5KW
16	Alto PC	1.2KW
6	ETC source 4 Pars	575W

### Miscellaneous items POA

3 x ETC 2 port, portable NET3 ACN gateway (can be input or output)  
1 x ETC 1 port, portable NET3 ACN gateway (can be input or output)  
1 x MDG Atmosphere hazer  
1 x MDG ATme hazer  
3 x Look Solution Unique 2 hazers  
2 x Look Solution Viper NT fog generators  
1 x Look Solution Tiny C07 small battery-driven fog generator  
2 x 16inch mirror balls  
1 x Anytronics DMX strobe  
2 x Thunderdroom 3000 DMX strobe  
1 x 6 way Le-Maitre Pyro firing unit  
1 x Bomb tank  
10 x Le-Maitre pyro firing pods – 2 x angled pods  
Various birdies, various stands/cables/multicores etc.  
60 x RAT music stands shared between venues

**Visiting companies must supply their own gel** though a small stock of Pre-cut colour is available FOC

**Use of Pyrotechnics, smoke, vapour, laser & other special effects.**

The Lowry MUST be informed prior to the production arriving at the venue that a company intends to use special effects. The full details along with risk assessments must be supplied and in some cases these need to be passed to the licensing authorities before authorisation to use them is granted.

## **Sound and communications**

---

### **Audio tie line infrastructure**

Audio tie lines terminating on control room audio jack field. 48 way starquad audio tie line loop, terminating on multi-pin sockets in the control room, rear auditorium and DSR, to enable the mixing console to be located in these positions.

### **Loudspeaker line infrastructure**

Loudspeaker lines on NL4 sockets terminated on audio rack loudspeaker patch.

### **Sound mixing console**

Soundcraft Vi3000 Digital Console with digital stage box

*Subject to availability alternative house consoles are:*

Soundcraft Vi1000 Digital Console with digital stage box

Yamaha QL5 Digital Console with RIO 3224D stage box

Allen & Heath Mix Wizard 14:4:2 10 mic channels/2 Stereo Channels

### **Standard loudspeaker system** (Suitable for spoken word, theatre playback & comedy)

6 x L'Acoustics 12 XTi Mounted left & right at stalls; Tier 1 & Tier 2

4 x L'Acoustics SB18 sub bass

### **Additional loudspeaker system**

(For music gigs & louder theatre shows, subject to a hire cost)

4 x L'Acoustics ARC

4 x L'Acoustics ARC Focus with SB18 sub bass hung as a centre cover

2 x L'Acoustics 8 XTi rear delays

2 x L'Acoustics 8 XT front fills

**Loudspeakers non-installed** (Subject to availability and a hire cost; up to 4 wedges are included per venue)

Foldback / effects:

6 x APG DX12 (can run as 6 mixes, 4 flying frames available)

8 x APG DX15 (can run as 8 mixes)

8 x Nexo PS-15 (Can run as 6 mixes; 6 flying frames available)

2 x Meyer UPA 1P (Self Powered; No flying frames)

4 x Meyer UPA 1C (4 channels of amps; 4 flying frames available)

Extra Sub bass

2x Nexo LS-1200 (Can run with PS15 as Drum fill or extra FoH)

Power amplifiers:

APG

Lab Gruppen

SA 30:2

1300C



### **Outboard equipment**

1 X Mac Mini with stereo Q-Lab 3 and Q-lab 4

### **Extra outboard equipment available**

(This equipment is shared between 3 theatre spaces corporate facilities & must be booked in advance)

3 x XTA GQ600 Two channel 1/3 equaliser

1 x BSS DPR504 Four channel noise gate

1 x TC electronic D-Two Delay

1 x Yamaha SPX2000 Digital effects (in with Vi 3000)

1 x Roland RD-700 Electric piano

### **Microphones**

(This equipment is shared between 3 theatre spaces corporate facilities & must be booked in advance)

8 x Shure Beta 58

8 x Shure 58

4 x Shure Beta 57

4 x Shure 57

2 x Shure Beta 87

5 x Sennheiser MKH40

4 x Sennheiser MKH60

4 x Sennheiser E604 Evo drum mics

8 x Crown PCC160

1 x AKG 414B-ULS

2 x AKG 414B-XLS

8 x AKG CK91

2 x Beyer 201

2 x Beyer M88

1 x Beta Shure 52

4 x DPA 4099 (Classical kit)

2 x Budget switched vocal mics

10 x BSS Active DI

Selection of stands, cables, connectors etc.

### **Radio microphones** (Subject to availability and a hire cost)

1 x Shure ULX-D 2 way receiver racks

2 x Shure ULX-D 4 way receiver racks

4 x Shure ULX-D Handheld radio mics with SM58 or SM58 Beta

2 x Shure ULX-D Handheld radio mics with SM58

6 x Shure ULX-D body pack

6 x Shure MX 185 clip mic heads

6 x DPA 4061 clip mic heads

6 x DPA 4066 head mics

2 x Shure GLX-D 2.4Ghz SM58 systems (Suitable for Q&A; God Mic use etc)

Selection of stands, cables, connectors are available.

**Please check with the technical department for frequencies available for toured equipment. Please note we hold a venue licence for shared channel 38 but this may be allocated to another production. Please be advised that Media City is located next to our venue and uses some Channel 38 radio mics, we would always recommend using site specific licenced channels where possible. We hold 23 spot frequencies on channel 40-45 which are allocated to our own theatre radio mics & corporate AV department radio mics. By request 5 of these frequencies are available for tour use. On occasion we are able to release spot frequencies held for house equipment to allow tours to book whole blocks of channels. This must be agreed in advance and requires us as the venue to authorise their release to OFCOM :**

626.000(40); 626.600(40); 630.850(41); 636.600(41); 638.200(42)

**Specific frequency allocations MUST be approved in advance of arrival to avoid issue with other productions & events taking place at the same time. The Lowry will not permit the use of radio equipment without this advanced detailed notice.**

## **Stage managers desk; Ring intercom & Video System**

---

A mobile GDS SM desk connects either stage left or stage right, paging control and four-channel Clearcom Helixnet digital intercom master station & cue light control, patchable system with boxes normally located at LX control, sound control & fly floor please check for availability of Q-lights boxes. The desk is equipped with 3 colour video monitors. A BNC 75ohm patching system with distribution is available. 2 video cameras: 1 x colour, 1 x IR Camera Show relay and call system to backstage areas are installed.

Clear-com digital Helixnet party line coms system & 4 way RTS radio coms system is installed. Helixnet twin channel belt packs and headsets are located at LX control, sound control, fly floor, follow-spots & Stage Mangers desk. Please check for availability of additional sets.

### **Assisted listening system**

Two channel Sennheiser infrared listening system suitable for use by hearing impaired persons & audio description.

A Sennheiser Mobile Connect system is installed for customers to access show relay and audio description, when available, via compatible mobile devices.

### **AV Equipment**

Subject to availability and a hire cost:

1 x Panasonic PT-DZ770EJK (7,000 Lumen single chip DLP projector).

1 x Panasonic RZ970 (10,000 Lumen, laser light source)

Each projector has a flying frame supplied with a lens which we have the options of a Standard lens (1.7 – 2.3) or Short throw lens (0.8 –1).

1 x 4.2m x 3.6m screen with front and rear surface options is available (This gives a 16x9 ratio screen size)

A MacBook Pro can be supplied for PowerPoint; Keynote or QLab3 and Q-lab 4 (Stereo Audio only from the on-board sound card)

Other projector options are hired in from a local AV firm whom we are able to obtain competitive rates from. Please enquire if you have a specific AV set-up you require.

350KG UDL,

Front of Stage	From front	From Tabs	Description
<b>Track</b>	0.8	0	House tabs
1	0.9	0.1	1m soft black border
2	1.25	0.45	Standard Rig LX 1 Bar
3	1.45	0.65	
4	1.65	0.85	
5	1.85	1.05	
6	2.05	1.25	
7	2.25	1.45	
8	2.45	1.65	
9	2.65	1.85	
10	2.85	2.05	
11	3.05	2.25	
12	3.25	2.45	Standard Rig LX 2 Bar
<b>RSJ</b>	<b>RSJ</b>	<b>RSJ</b>	
13	3.85	3.05	
14	4.05	3.25	
15	4.25	3.45	
16	4.45	3.65	
17	4.65	3.85	
18	4.85	4.05	
19	5.05	4.25	
20	5.25	4.45	
21	5.45	4.65	
22	5.65	4.85	
23	5.85	5.05	Standard Rig LX 3 Bar
<b>RSJ</b>	<b>RSJ</b>	<b>RSJ</b>	
24	6.45	5.65	
25	6.65	5.85	
26	6.85	6.05	
27	7.05	6.25	
28	7.25	6.45	Standard Rig Back Light LX bar
29	7.45	6.65	
30	7.65	6.85	Standard Rig Cyc flood bar
31	7.85	7.05	
32	8.05	7.25	
33	8.25	7.45	
34	8.45	7.65	Standard Rig Cyc Bar
Track	8.9	8.1	With Split Full blacks
Back Wall	9.95	9.15	

## Technical Contacts

---

The Lowry Theatre  
Pier 8  
Salford Quays  
M50 3AZ

Administration	0161 876 2020
Stage Door	0161 876 2107
Box Office	0161 876 2000
Security (24hrs)	0161 876 2111

---

Please can all advance show information be sent to Phil Maxim.

### Head of Technical Theatre

**Phil Maxim**

Direct Line 0161 876 2073

Email [phil.maxim@thelowry.com](mailto:phil.maxim@thelowry.com)

### Technical Manager

**David Clare**

Direct Line 0161 876 2047

Email [david.clare@thelowry.com](mailto:david.clare@thelowry.com)

### Technical Manager

**Adam Fuller**

Direct Line 0161 876 2053

Email [adam.fuller@thelowry.com](mailto:adam.fuller@thelowry.com)

### Technical Manager

**Andy Meyers**

Direct Line 0161 876 2108

Email [andrew.meyers@thelowry.com](mailto:andrew.meyers@thelowry.com)

### Technical Manager

**David Wimpenny**

Direct Line 0161 876 2170

Email [david.wimpenny@thelowry.com](mailto:david.wimpenny@thelowry.com)

---